

T4S R66W SEC 12

1975-01

Revisions

CODE	DATE	CASE	Zoning	FROM	TO
001	08/07/62	Original	Zoning		
002	08/27/63	Z63-52	A-1	R-A	
003	04/14/64	Z64-13	A-1	O	
004	06/13/67	Z67-6	A-1	A2	
005	05/14/73	Z72-59	A-1	A-2	
006	07/19/76	Z76-10	A-1	R-A	
007	04/02/79	Z78-43	A-1	A-2, F	
008	09/10/85	AO 85-87	A-1	AURORA	
009	01/26/87	AO 86-169	A-1	AURORA	
010	01/26/87	AO 86-170	A-1	AURORA	
011	01/26/87	AO 86-171	A-1	AURORA	
012	03/12/91	AO 90-130	A-1, RA	AURORA	
013	06/04/98	AO 98-18	A-1	AURORA	
014	06/04/98	AO 98-18	A-1	AURORA	
015	06/04/98	AO 98-20	A-1, A-2	AURORA	
016	03/03/15	Z14-008	A-1, R-A	F, A-1	
017	03/03/15	P14-018		MF	
018	04/10/18	Z17-002	A-2	PUD	

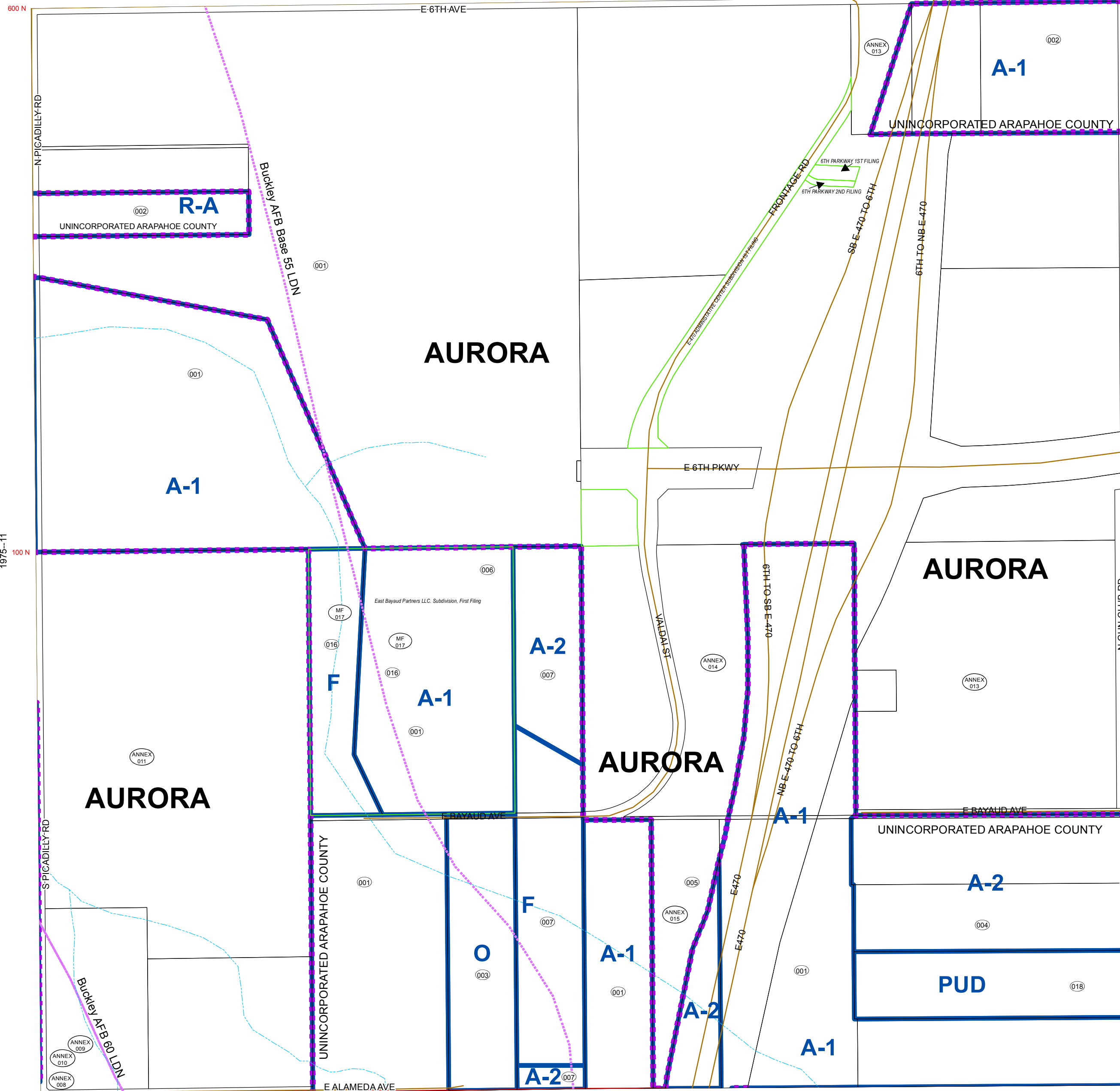

1975-11

1977-07

Roads 1975-13

Parcels

Subdivisions

Zoning Restrictions

Zoning

Jurisdictions

Airport Influence Area

Code Sec
1975 12

Date Saved: 1/28/2019 1:16:47 PM

General Disclaimer:
 Arapahoe County Makes No Representation Or Warranty As To The Accuracy Of This Base Map, And Assumes No Responsibility Or Liability To Any User. This Base Map Is Not A Legal Document . It Is Intended To Serve As An Aid In Graphic Representation Only.

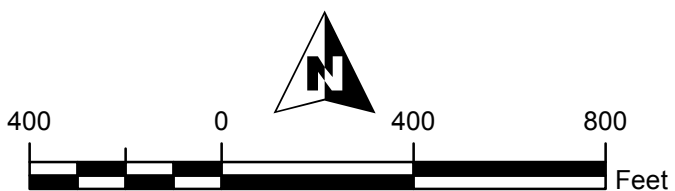

T4S	R66W	R67W	R68W	R69W	R70W	R71W	R72W	R73W	R74W	R75W	R76W	R77W
1971	1973	1975	1977	1979	1981	1983	1985	1987	1989	1991	1993	
2077	2075	2073	2071	2069	2067	2065	2063	2061	2059	2057	2055	