

T4S R65W Adams County

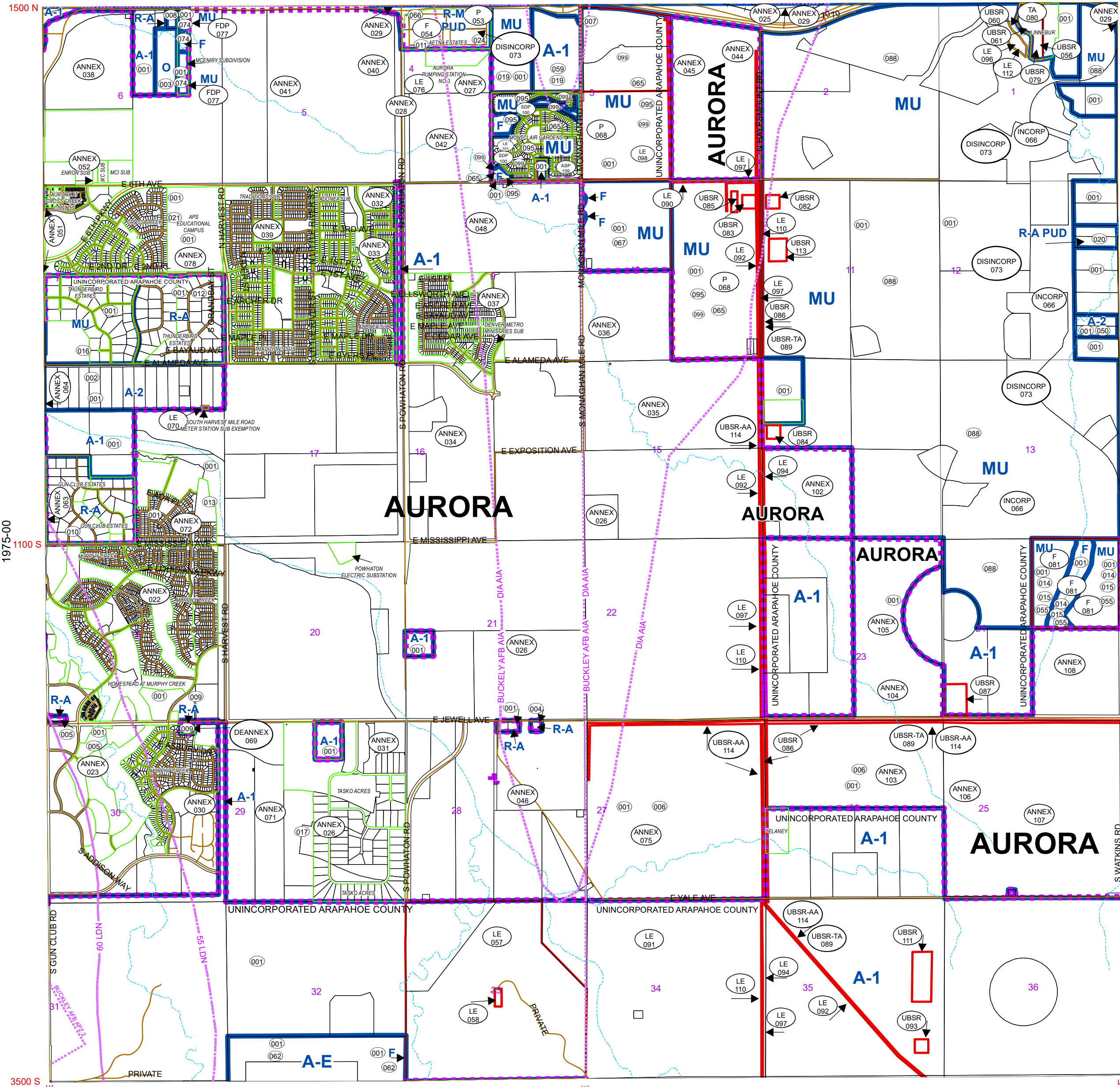

REVISIONS

CODE	DATE	CASE	FROM	TO
001	08/07/61			A-1.RM
002	02/18/64	284-054	A-1	A-2
003	11/25/66	286-025	A-1	O
004	06/28/67	287-010	A-1	R.A
005	07/17/67		A-1	R.A
006	08/13/68	PER ZONING RESOLUTION	A-1	A-1
007	08/29/69	289-000	A-1	B-5
008	01/28/70	289-035	O	R.A
009	09/23/70	Z70-008	A-1	R.A
010	03/02/71	Z70-034	A-1	R.A
011	05/17/71	Z71-004	A-1	R.M PUD
012	01/18/73	Z72-035	A-1	R.A. A-2
013	03/19/73	Z72-050	A-1	O
014	11/08/73	Z72-028	A-1	O
015	09/21/76	Z76-012	O	MU
016	10/10/78	Z78-025	A-1.A-2.R.A	MU
017	10/10/78	Z78-018	A-1	R.A
018	06/08/80	AD012	A-1	PUD
019	10/02/79	Z79-024	A-1	MU
020	05/04/82	281-062	A-1	R.A PUD
021	06/26/84	283-034	A-1	MU
022	06/18/86	AD 1985-251	A-1	AURORA
023	06/18/86	AD 1985-252	A-1	AURORA
024	07/22/86	A86-020	A-1	MU
025	09/18/86	AD 1985-347	A-1	AURORA
026	09/18/86	AD 1985-260 thru 265	A-1, R.A	AURORA
027	09/29/86	AD 1986-002	A-1	AURORA
028	09/29/86	AD 1986-003	A-1	AURORA
029	11/23/86	AD 1986-369	A-1	AURORA
030	01/26/87	AD 1985-279	A-1, R.A	AURORA
031	01/26/87	AD 1985-280	A-1	AURORA
032	01/26/87	AD 1985-284	A-1	AURORA
033	01/26/87	AD 1985-283	A-1	AURORA
034	01/26/87	AD 1985-281	A-1	AURORA
035	01/26/87	AD 1985-282	A-1	AURORA
036	01/26/87	AD 1985-285	A-1	AURORA
037	04/21/87	AD 1987-67	A-1	AURORA
038	04/21/87	AD 1987-69	A-1	AURORA
039	04/21/87	AD 1987-75	A-1	AURORA
040	04/21/87	AD 1987-189	A-1	AURORA
041	04/21/87	AD 1987-190	A-1	AURORA
042	04/21/87	AD 1987-191	A-1	AURORA
043	04/21/87	AD 1986-192	A-1	AURORA
044	04/21/87	AD 1986-198	A-1	AURORA
045	04/21/87	AD 1986-197	A-1	AURORA
046	08/10/87	AD 1986-237	A-1	AURORA
047	02/16/88	AD 1987-119	A-1, M-U	AURORA
048	06/08/89	AD 1989-42	A-1	AURORA
049	06/18/87	Z87-001	A-1, B-5	MU, F
050	03/08/89	Z89-021	A-1	A-2
051	03/12/91	AD 1990-130	MU	AURORA
052	02/09/98	AD 1995-108	A-1	AURORA
053	12/17/98	A89-029	A-1	PDP
054	03/25/97	A97-008	A-1	FDP
055	02/03/98	Z97-002	MU	MU, F
056	09/15/98	U98-004	A-1	UBSR
057	08/17/98	U98-016	A-1	LE
058	08/17/98	U98-003	A-1	LE
059	10/31/00	Z00-010	MU	A-1
060	05/14/02	U01-002	A-1	UBSR
061	01/06/03	U02-003	A-1	UBSR
062	08/17/03	Z03-009	A-1	MU, F
063	09/09/03	AD 2001-096	R.A	AURORA
064	09/18/03	AD 2001-097	A-1, F	AURORA
065	01/06/04	Z01-010	MU, A-1, F	MU, F
066	06/30/04	INCORP. TOWN OF WATKINS	A-1	WATKINS
067	10/12/04	Z04-005	A-1	MU, F
068	04/22/05	AD 010	A-1	PDP
069	08/29/05	AD 2005-118	MU	AURORA DE ANNEX
070	12/06/05	L05-006	A-1	AURORA
071	07/15/06	AD 2006-33	A-1	LE
072	09/11/06	AD 2005-90	A-1, O	AURORA
073	11/30/06	Z06-006	A-1, F	WATKINS DISINCORPORATION
074	12/05/06	Z05-006	MU, F	MU, F
075	04/23/07	AD 2007-008	A-1	AURORA
076	09/18/07	L07-004	A-1	LE
077	01/08/08	P07-010	MU	FDP
078	12/27/08	AD 2008-068	A-1, MU	AURORA
079	08/25/09	U07-003	A-1	UBSR
080	12/13/09	TA10-024	A-1	UBSR-TA
081	06/06/12	P11-005	A-1	FDP
082	03/21/14	OG13-008	A-1	UBSR
083	04/02/14	OG13-006	A-1	UBSR
084	04/18/14	OG13-007	A-1	UBSR
085	05/06/14	OG14-004	A-1	UBSR
086	06/17/14	U14-001	A-1	UBSR
087	09/16/14	U14-003	A-1	UBSR
088	02/10/15	Z15-102	A-1, R.A	MU, F
089	02/11/15	TA14-012	A-1, R.A	UBSR-TA
090	02/03/15	L14-002	A-1	LE
091	07/07/15	L15-001	A-1	LE
092	03/19/16	L16-001	A-1	LE
093	09/07/16	OG16-001	A-1	UBSR
094	09/18/16	A16-007	A-1	LE
095	11/25/16	Z16-003	MU, F	MU, F
096	12/20/16	L16-002	A-1	LE
097	02/27/17	TA16-004	A-1	LE
098	11/21/17	L17-007	A-1	LE
099	01/23/18	E17-006	MU, F	PDP
100	02/06/18	P17-013	A-1	SSDP
101	06/19/18	L18-002	A-1	LE
102	08/02/18	AD 2017-281	MU	AURORA
103	08/02/18	AD 2017-092	A-1	AURORA
104	08/02/18	AD 2017-063	A-1	AURORA
105	08/02/18	AD 2017-064	A-1	AURORA
106	08/02/18	AD 2017-065	A-1	AURORA
107	08/02/18	AD 2017-066	A-1	AURORA
108	08/02/18	AD 2017-067	A-1	AURORA
109	08/08/18	ASP18-004	A-1	ASP
110	12/06/18	TA17-005	A-1	LE
111	12/06/18	AE18-007	A-1	UBSR
112	12/27/18	AA18-015	A-1	LE
113	05/09/19	AE18-010	A-1	UBSR
114	06/12/19	AA19-004	A-1	UBSR-AA

Code Sec 1977 00 Date Saved: 6/18/2019 12:01:12 PM

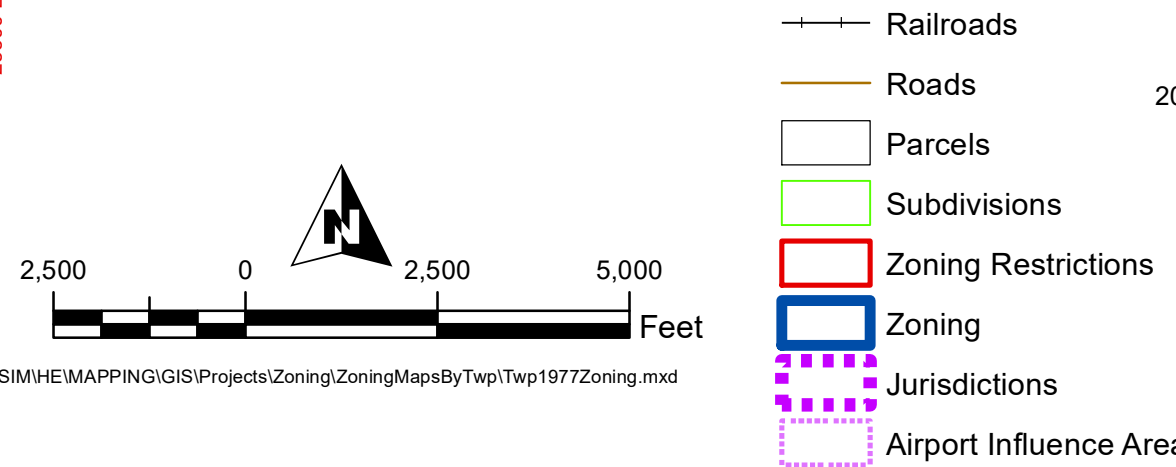

General Disclaimer: Arapahoe County Makes No Representation Or Warranty As To The Accuracy Of This Base Map, And Assumes No Responsibility Or Liability To Any User. This Base Map Is Not A Legal Document . It Is Intended To Serve As An Aid In Graphic Repres entation Only.

Grid of Township and Range coordinates:

T4S	R68W	R67W	R66W	R65W	R64W	R63W	R62W	R61W	R60W	R59W	R58W	R57W
1971	1973	1975	1977	1979	1981	1983	1985	1987	1989	1991	1993	
2077	2075	2073	2071	2069	2067	2065	2063	2061	2059	2057	2055	